

004-68001-0 SuterClutch KTM RC390 2016-2017 Duke 390

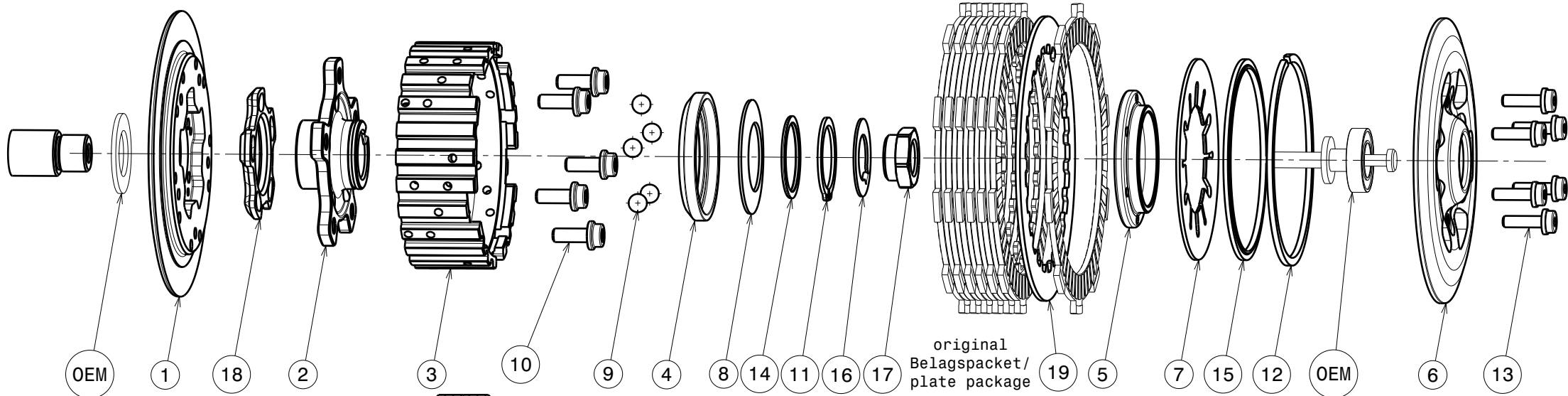

-Die Scheibe Nr.16 biegen um die Mutter zu sichern!
-Bend the washer No.16 to lock the nut!

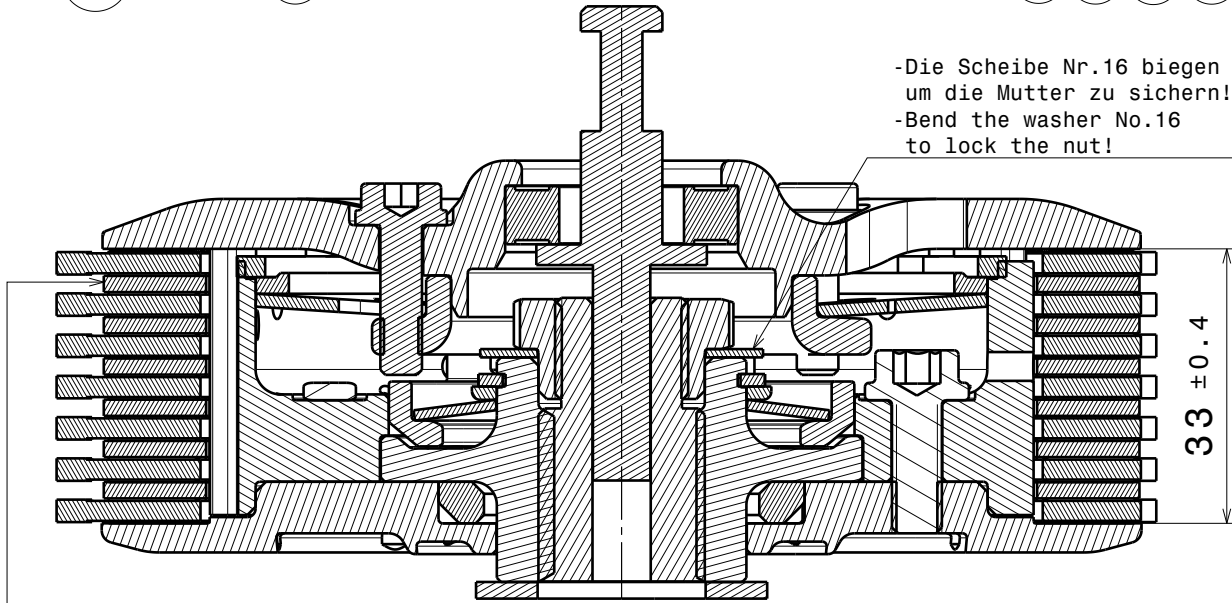

Diese Stahlscheibe muss durch die mitgelieferte (Pos.19) ersetzt werden
This steel disk has to be replaced with the delivered one (Pos.19)

Partlist: 2064

| ITEM | PART NAME | SRT NUMBER | QTY |
|------|-----------------------------------|------------------|----------|
| 1 | Back Plate | 004-14721 | 1 |
| 2 | Hub Carrier | 004-68700 | 1 |
| 3 | Inner hub | 004-68740 | 1 |
| 4 | Release Ring | 004-15975 | 1 |
| 5 | Clamp Hub 5mm | 004-00505 | 1 |
| 6 | Pressure Plate | 004-68940 | 1 |
| 7 | Disk Spring Main ø88 1310N | 004-88131 | 1 |
| 8 | Torque Limiter Spring 950N | 004-50095 | 1 |
| | Torque Limiter Spring 850N | 004-50085 | (1) |
| | Torque Limiter Spring 1100N | 004-50110 | (1) |
| 9 | Ball 8mm | 004-17801 | 5 |
| 10 | Bolt M6x16 | 004-17816 | 5 |
| 11 | Circlip 30mm | 004-00030 | 1 |
| 12 | Circlip 90mm | 004-17804 | 1 |
| 13 | Distance Bolt M5 L=18.0mm | 004-05180 | 6 |
| 14 | Distance Ring 30x36x1.6 | 004-997303616 | 1 |
| 15 | Locking Ring 88mm | 004-00688 | 1 |
| 16 | Locking Washer 20/34 | 004-00670 | 1 |
| 17 | Nut M16x1.5-LH | 004-68955 | 1 |
| 18 | Ramp Insert 30° | 004-00722 | 1 |
| 19 | Steel Disk RC390 | 004-9966810 | 1 |

Das angegebene Belagpaketmass ist zwingend einzuhalten!
The plate package thickness must be strictly adhered to!