

004-55004-0 SuterClutch

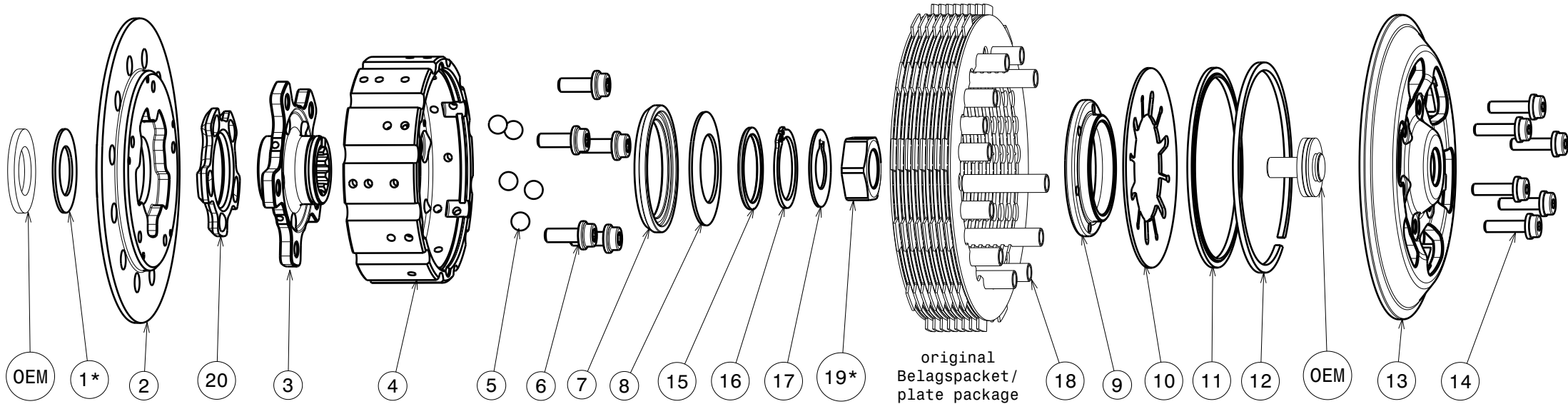

Für Modell For Model	Thrust Washer
250cc 13-14	Pos. 1*
250cc 15-	OEM Washer
350cc	OEM Washer
450cc	Pos. 1*
500/501/510cc	Pos. 1*

In jedem Einbaufall: nur **eine** Scheibe verwenden!
In any case: use only **one** of the 2 washers!

Für Modell For Model	Main Nut
250cc	Pos. 19
350cc	Pos. 19
450cc	OEM Nut
500/501/510cc	OEM Nut

-Die Scheibe Nr.17 biegen um die Mutter zu sichern!
-Bend the washer No.17 to lock the nut!

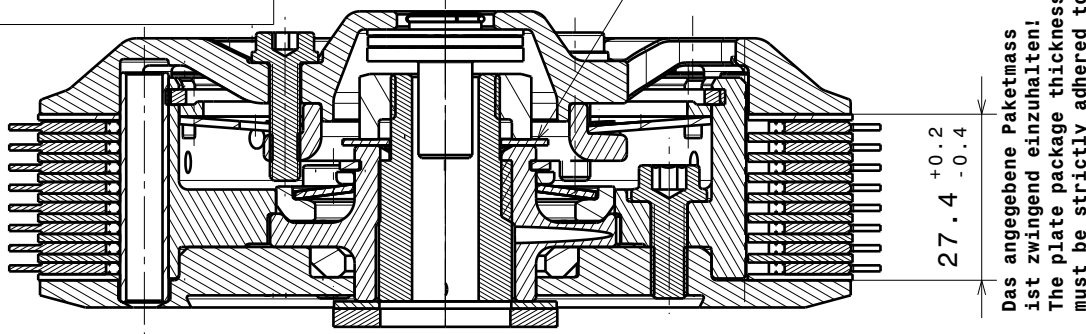

Das angegebene Paketmass ist zwingend einzuhalten!
The plate package thickness must be strictly adhered to!

Partlist: 1887			
ITEM	PART NAME	SRT NUMBER	QTY
1	Thrust Washer	004-55901	1
2	Back Plate KTM Insert	004-55723	1
3	Hub Carrier	004-55702	1
4	Inner Hub	004-55740	1
5	Ball 8mm	004-17801	5
6	Bolt M6x16 Hexagon Socket	004-17816	5
7	Release Ring	004-09975	1
8	Torque Limiter Spring 950N	004-50095	1
	Torque Limiter Spring 850N	004-50085	(1)
	Torque Limiter Spring 1100N	004-50110	(1)
9	Clamp Hub 5.0mm	004-00505	1
10	Disk Spring 1235N	004-88123	1
11	Locking Ring 88mm	004-00688	1
12	Circlip 90	004-17804	1
13	Pressure plate	004-55940	1
14	Distance Bolt M5x19.5	004-05195	6
15	Distance Ring 30x36x2	004-17610	1
16	Circlip 30mm	004-00030	1
17	Locking Washer 18/34/1mm	004-08670	1
18	Sleeve 38mm	004-55990	12
19	Nut M18x1.5	004-55955	1
20	Ramp Insert 30°	004-00722	1

Husaberg		Husqvarna						KTM							
450 FE FC	510 FE FC	250 FE	250 FC	350 FE	350 FC	450 FS	450 FE FC	501 FE FC	250 SX-F	250 EXC-F	350 SX-F	350 EXC-F	450 SX-F EXC	450 SMR	500 EXC
2013	2013	2014	2014	2014	2014	2015	2014	2014	2013	2013	2010	2012	2012	2013	2012
-	-	-	-	-	-	-	-	-	-	-	-	-	-	-	-
2015	2015	2017	2015	2017	2015	2016	2017	2017	2015	2017	2015	2017	2017	2014	2017