

004-55002-9 SuterClutch

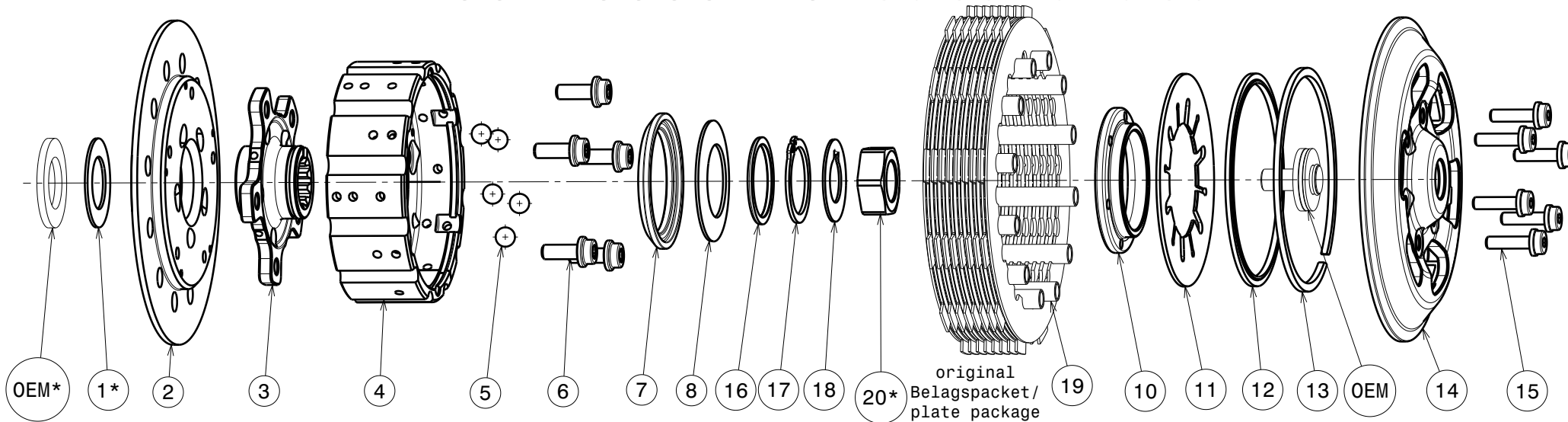

Für Modell For Model	Thrust Washer
250cc 13-14	Pos. 1*
250cc 15-	OEM Washer
350cc	OEM Washer
450cc	Pos. 1*
500/501/510cc	Pos. 1*

In jedem Einbaufall: nur **eine** Scheibe verwenden!
In any case: use only **one** of the 2 washers!

Für Modell For Model	Main Nut
250cc	Pos. 20
350cc	Pos. 20
450cc	OEM Nut
500/501/510cc	OEM Nut

-Die Scheibe Nr.18 biegen um die Mutter zu sichern!
-Bend the washer No.18 to lock the nut!

Das angegebene Paketmass ist zwingend einzuhalten!
The plate package thickness must be strictly adhered to!

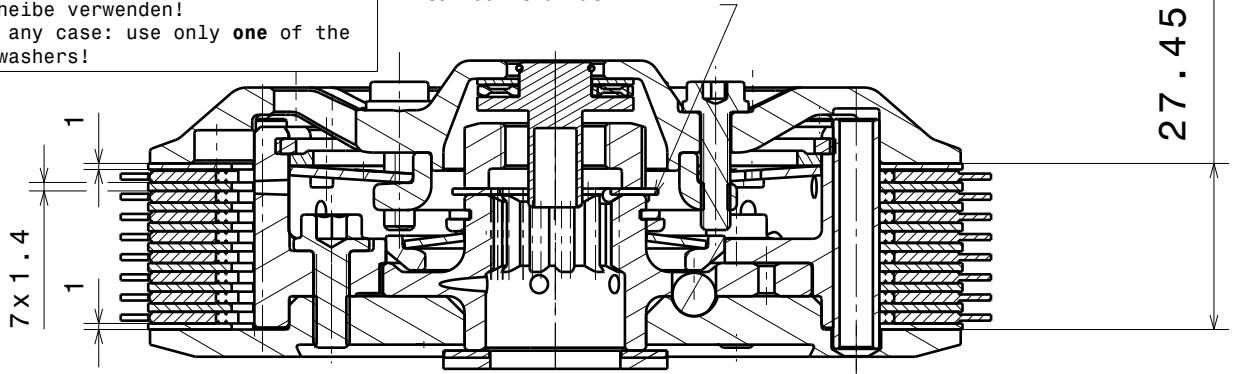

ITEM LIST (687)			
ITEM	PART NAME	SRT NUMBER	QTY
1	THRUST WASHER	004-55901	1*
2	BACK PLATE 30°	004-55720	1
3	HUB CARRIER	004-55702	1
4	INNER HUB	004-55740	1
5	BALL 8mm	004-17801	5
6	SCREW M6x16	004-17816	5
7	RELEASE RING	004-09975	1
8	TORQUE LIMITER SPRING 950N	004-50095	1
8.1	TORQUE LIMITER SPRING 850N	004-50085	1
8.2	TORQUE LIMITER SPRING 1100N	004-50110	1
8.3	TORQUE LIMITER SPRING 750N (CROSS)	004-50075	1
10	KLAMP HUB 5.0mm	004-00505	1
11	DISK SPRING MAIN 47x88x 1235N	004-88123	1
12	LOCKING RING 88mm	004-00688	1
13	CIRCLIP 90	004-17804	1
14	PRESSURE PLATE	004-55940	1
15	DISTANCE SCREW M5x19.5	004-05195	6
16	DISTANCE RING 30x36x2	004-17610	1
17	CIRCLIP 30mm	004-00030	1
18	LOCKING WASHER	004-08670	1
19	SLEEVE 38mm	004-55990	12
20*	NUT M18x1.5	004-55955	1

Husaberg		Husqvarna							KTM							
450 FE FC	510 FE FC	250 FE	250 FC	350 FE	350 FC	450 FS	450 FE FC	501 FE FC	250 SX-F	250 EXC-F	350 SX-F	350 EXC-F	450 SX-F EXC	450 SMR	500 EXC	
2013	2013	2014	2014	2014	2014	2015	2014	2014	2013	2013	2010	2012	2012	2013	2012	
-	-	-	-	-	-	-	-	-	-	-	-	-	-	-	-	
2015	2015	2016	2015	2016	2015	2016	2016	2016	2015	2016	2015	2016	2016	2014	2016	