

004-26050-1 SuterClutch Yamaha YZ450F MX 2007-2019

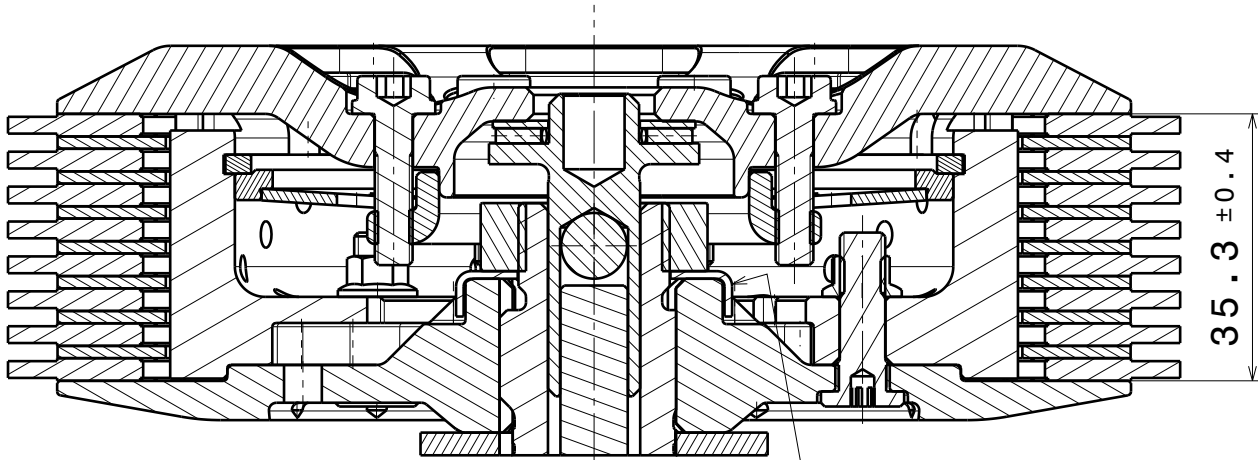
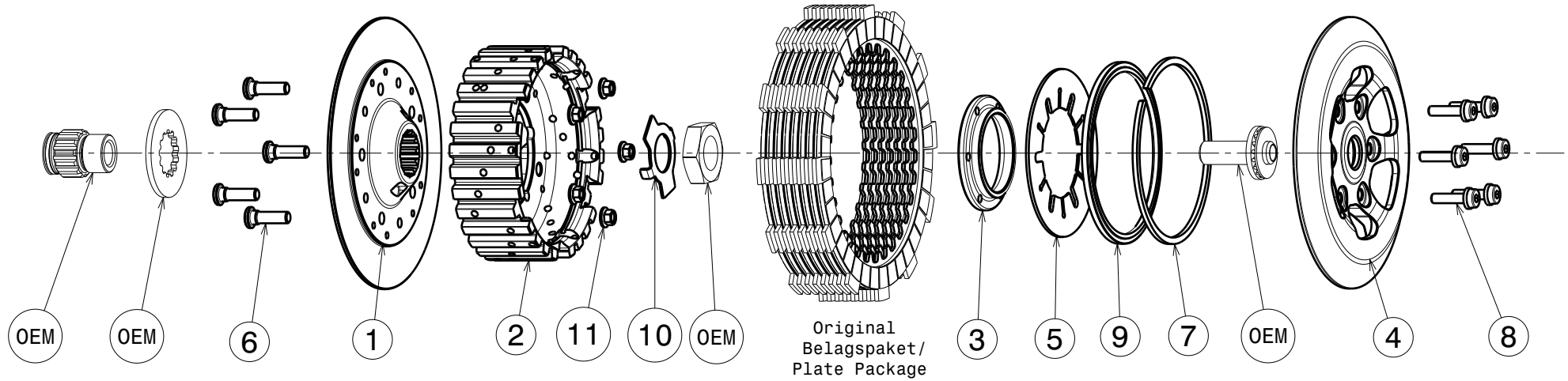

-Die Scheibe Nr.10 biegen um die Mutter zu sichern!
 -Bend the washer No.10 to lock the nut!

ITEMS LIST (1448)			
ITEM	PART NAME	SRT NUMBER	QTY
1	BACK PLATE PD	004-26725	1
2	INNER HUB	004-33741	1
3	CLAMP HUB 5mm	004-00505	1
4	PRESSURE PLATE	004-26943	1
5	Disk Spring Main ø88 1400N	004-88140	1
6	STUDS M6	004-12980	5
7	CIRCLIP 95mm	004-17813	1
8	DISTANCE SCREW M5x20.0	004-05200	6
9	LOCKING RING 95mm	004-00695	1
10	LOCKING WASHER 20/31/1mm MX	004-00671	1
11	NUT M6	999-12030605	5

-Das angegebene Belagspaketmass ist zwingend einzuhalten!

Einstellmöglichkeiten: Stahlscheibe (2.00mm) 5VY-16325-00
 Stahlscheibe (1.16mm) 5JG-16325-00

-The plate package thickness must be strictly adhered to!

Adjustment possibility: Steelplate (2.00mm) 5VY-16325-00
 Steelplate (1.16mm) 5JG-16325-00