

004-26004-3 SuterClutch Yamaha YZ450F 2007-2017

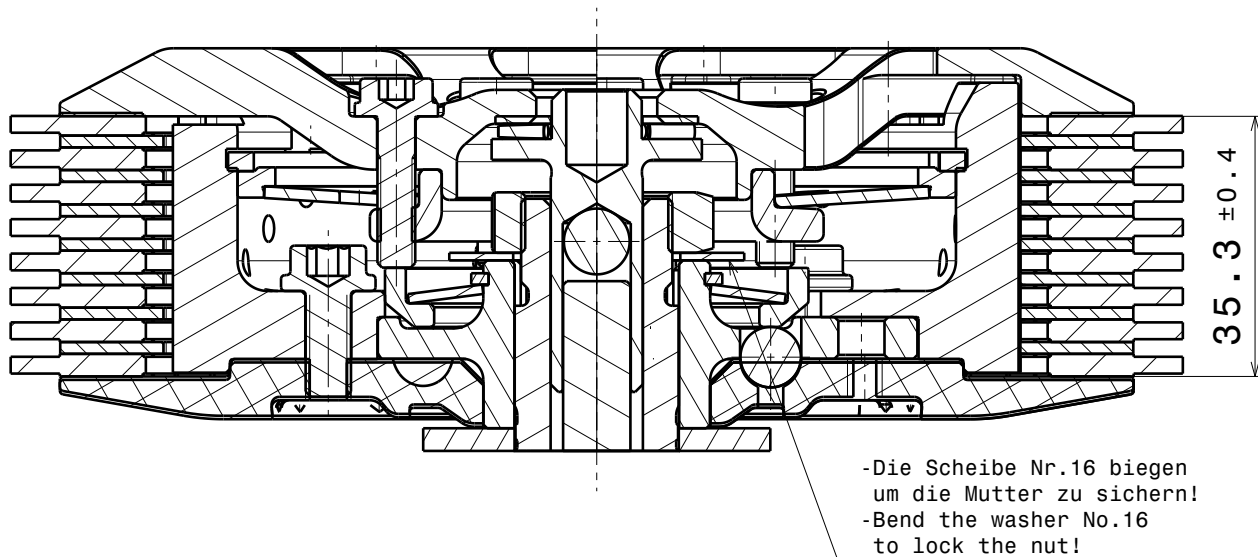
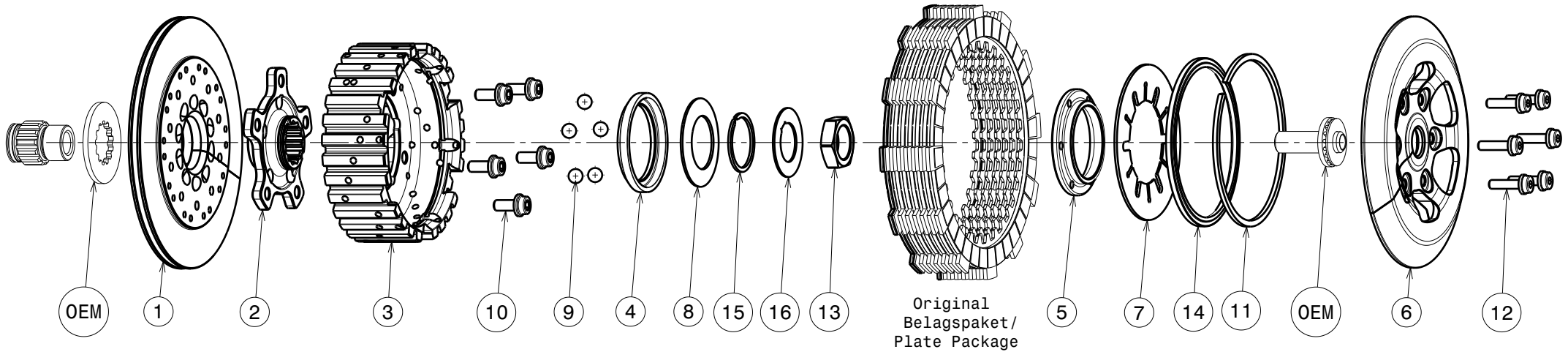

-Die Scheibe Nr.16 biegen um die Mutter zu sichern!
-Bend the washer No.16 to lock the nut!

-Das angegebene Belagspaketmass ist zwingend einzuhalten!
Einstellmöglichkeiten: Stahlscheibe (2.00mm) 5VY-16325-00
Stahlscheibe (1.16mm) 5JG-16325-00

-The plate package thickness must be strictly adhered to!
Adjustment possibility: Steelplate (2.00mm) 5VY-16325-00
Steelplate (1.16mm) 5JG-16325-00

ITEMS LIST (368)

ITEM	PART NAME	SRT NUMBER	QTY
1	BACK PLATE 30°	004-26723	1
2	HUB CARRIER	004-33700	1
3	INNER HUB	004-33741	1
4	RELEASE RING	004-15975	1
5	KLAMP HUB 5mm	004-00505	1
6	PRESSURE PLATE	004-26943	1
7	DISK SPRING MAIN 47x88x1235N	004-88123	1
8	TORQUE LIMITER SPRING 1100N	004-50110	1
8.1	TORQUE LIMITER SPRING 750N	004-50075	1
8.2	TORQUE LIMITER SPRING 950N	004-50095	1
8.3	TORQUE LIMITER SPRING 1300N	004-50130	1
9	BALL 8.0MM	004-17801	5
10	SCREW M6x14	004-17814	5
11	CIRCLIP 95mm	004-17813	1
12	DISTANCE SCREW M5x20.0	004-05200	6
13	NUT M20x1	004-998201080	1
14	LOCKING RING 95mm	004-00695	1
15	CIRCLIP 30mm	004-17803	1
16	LOCKING WASHER 22/39/1mm	004-07670	1