

004-22001-2 SuterClutch Yamaha WR250F/YZ250F 2001-2016

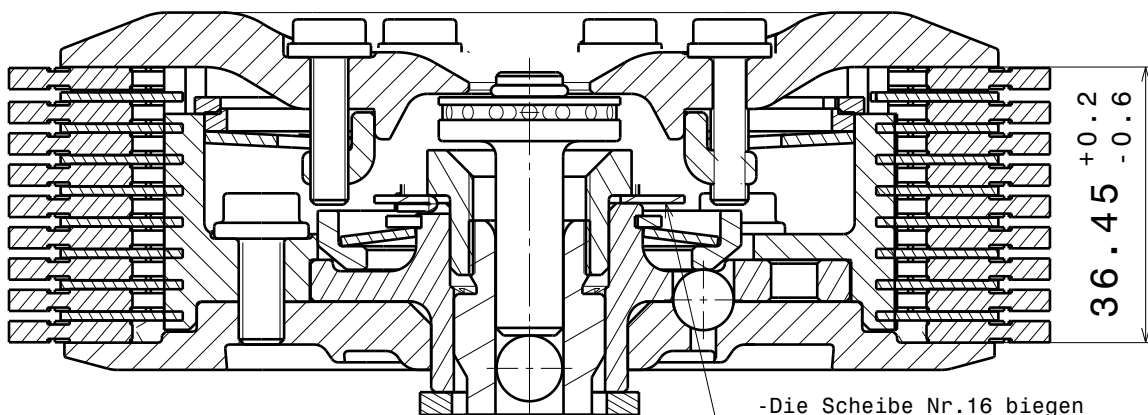
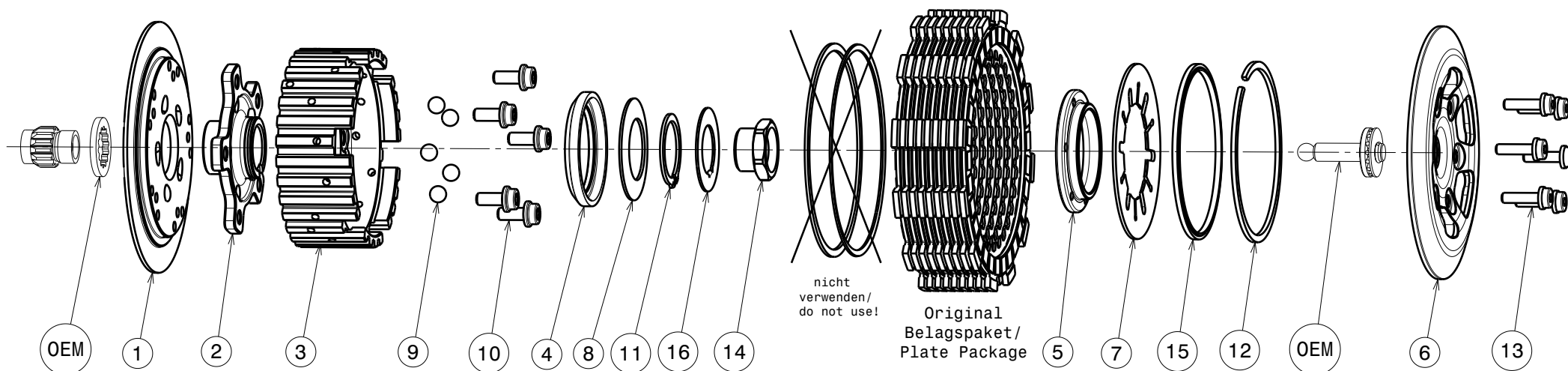

-Die Scheibe Nr.16 biegen um die Mutter zu sichern!
-Bend the washer No.16 to lock the nut!

Das angegebene Belagspaketmass ist zwingend einzuhalten!
The plate package thickness must be strictly adhered to!

ITEMS LIST (180)

ITEM	PART NAME	SRT NUMBER	QTY
1	BACK PLATE 30°	004-22720	1
2	HUB CARRIER	004-22700	1
3	INNER HUB	004-22740	1
4	RELEASE RING	004-15975	1
5	CLAMP HUB 5.0mm	004-00505	1
6	PRESSURE PLATE	004-22940	1
7	DISK SPRING MAIN 47x86x1000N	004-86100	1
8	TORQUE LIMITER SPRING 1300N	004-50130	1
8.1	TORQUE LIMITER SPRING 750N	004-50075	1
8.2	TORQUE LIMITER SPRING 1100N	004-50110	1
8.3	TORQUE LIMITER SPRING 1500N	004-50150	1
9	BALL 8.0MM	004-17801	5
10	SCREW M6x14	004-17814	5
11	CIRCLIP 30mm	004-17803	1
12	CIRCLIP 86mm	004-17886	1
13	DISTANCE SCREW M5x19.5	004-05195	6
14	NUT M16x1	004-22955	1
15	LOCKING RING 86mm	004-00686	1
16	LOCKING WASHER 24/41	004-37671	1