

004-06001-2 SuterClutch

KTM EXC-R 450/530 08-11

Husaberg 450

09-11

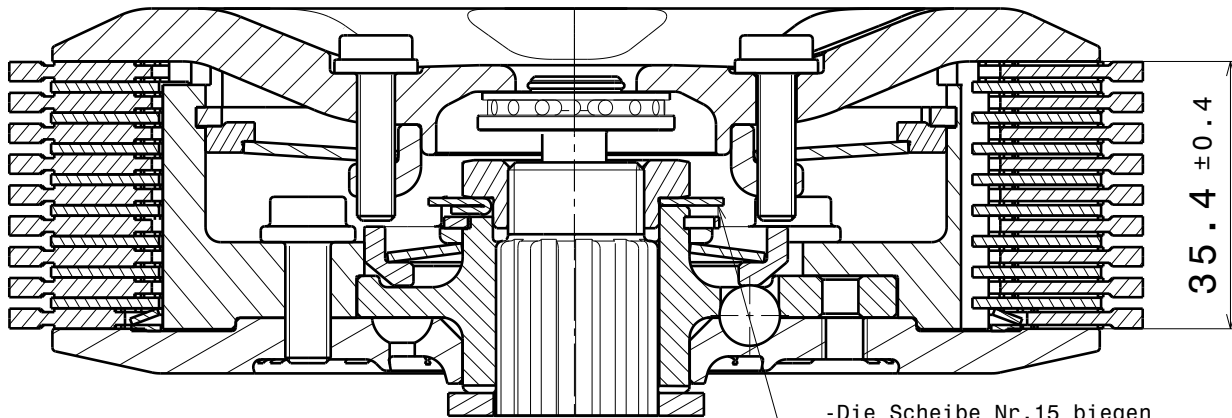
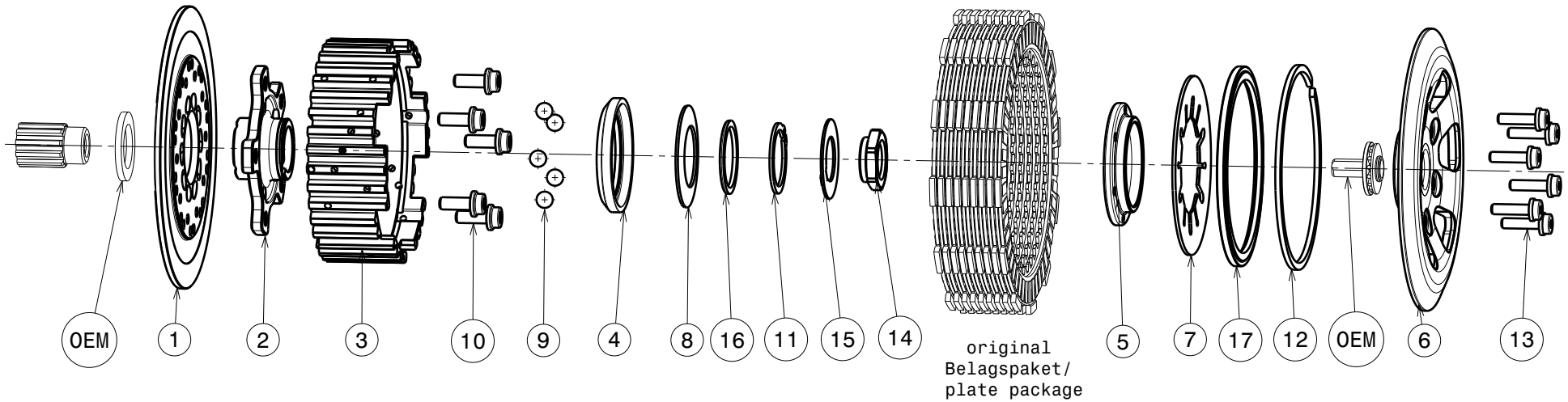

-Die Scheibe Nr.15 biegen um die Mutter zu sichern!
-Bend the washer No.15 to lock the nut!

Das angegebene Belagspaketmass ist zwingend einzuhalten!
The plate package thickness must be strictly adhered to!

ITEMS LIST 302

ITEM	PART NAME	SRT NUMBER	QTY
1	BACK PLATE <i>montiert 30°</i>	004-06721	1
2	HUB CARRIER	004-06700	1
3	INNER HUB	004-06740	1
4	RELEASE RING	004-15975	1
5	KLAMP HUB 5.0mm	004-00505	1
6	PRESSURE PLATE	004-06940	1
7	DISK SPRING MAIN 1235N	004-88123	1
8	TORQUE LIMITER SPRING 850N	004-50085	1
8.1	TORQUE LIMITER SPRING 750N	004-50075	1
8.2	TORQUE LIMITER SPRING 950N	004-50095	1
9	BALL 8.0MM	004-17801	5
10	SCREW M6x16	004-17816	5
11	CIRCLIP 30mm	004-00030	1
12	CIRCLIP 100mm	004-17833	1
13	DISTANCE SCREW M5x19.5	004-05195	6
14	NUT M18X1.5	004-06955	1
15	LOCKING WASHER 22/39	004-07670	1
16	DISTANCE RING 30X36X2	004-17610	1
17	LOCKING RING 98	004-00698	1